

Cable Display Instructions

(Ceiling to Floor System)

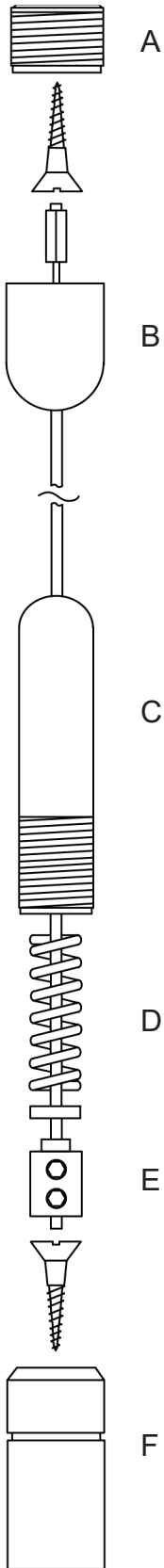

All fittings:

- A) Ceiling Mount
- B) Ceiling Cap
- C) Floor/Tensioner Cap
- D) Tension Spring
- E) Cable Stopper
- F) Floor Mount

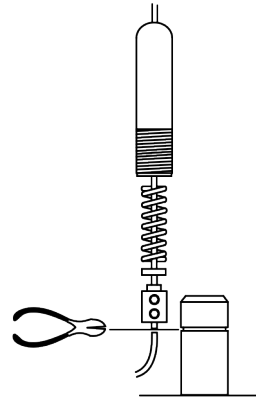

fig.1

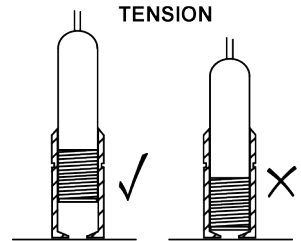

fig.2

IMPORTANT: It is essential to check that the top ceiling fixings are strong enough to suspend the weight of any items you intend to display, whilst allowing for the tension in the cables.

- 1) Screw **Fitting A** to the ceiling
 - 2) Screw **Fitting B** over **Fitting A** as tightly as possible
 - 3) Using a 'plumb-line', fix **Fitting F** to the floor
 - 4) Loosen the grub screws of **Fitting E**
 - 5) Now slide **Fitting C**, **Fitting D** and finally **Fitting E** onto the cable in that order
 - 6) Pull down and cut off the access cable in line with **Fitting F** guide line. **See fig.1**
 - 7) Tighten the grub screws of **Fitting E**
 - 8) Insert and screw **Fitting C** into **Fitting F** until the cable has no slack. **See fig.2**
- IMPORTANT:** DO NOT overly tighten the cable! Overly tightening can cause extra strain on the ceiling fixing, resulting in a premature failure of the system.

N.B. It is important to check the strength of the top fixings!
 No responsibility will be taken for an incorrect installation.
 This responsibility rest with the installer.
 Cable fittings are not supplied with the fixing screws/bolts etc.



peakrock.com & artestuff.com

Head Office: Peak Rock Ltd • Unit 4 Horizon Business Centre • Veridion Park • Kent • DA18 4AJ • UK
 Showroom: Unit 30 DRCA Business Centre • Battersea Park • London • SW11 5HD • UK

Office Tel (UK): +44 (0)20 8320 8800
 Office Fax (UK): +44 (0)20 8311 7777
 Tel Sales (USA): 888 608 8444
 Email: sales@artestuff.com